

REVISIONS				
ECN	REV.	DESCRIPTION	DATE	APPROVED
	A	RELEASE FOR PRODUCTION	10-12-11	
	B	ADD 4 UNC 6-32 FLATHEAD SCREWS IN ENDCAP	10-12-11	
	C	REVISED DIMENSIONS AND ADDED END CAPS	07-20-17	
18053	D	ASSEMBLY DRAWING AND BOM ADDED ENCLOSURE UPDATED TO CURRENT STANDARDS GRILLE LENGTH FIXED	11-29-18	
19008	E	REVISED END CAP HOLES, PIGTAIL MADE 0.250"	02-27-19	
21041	F	REVISED WITH 10-32 HOLES ON END CAPS GRILLE DEPTH CHANGED TO 0.600"	08-04-21	

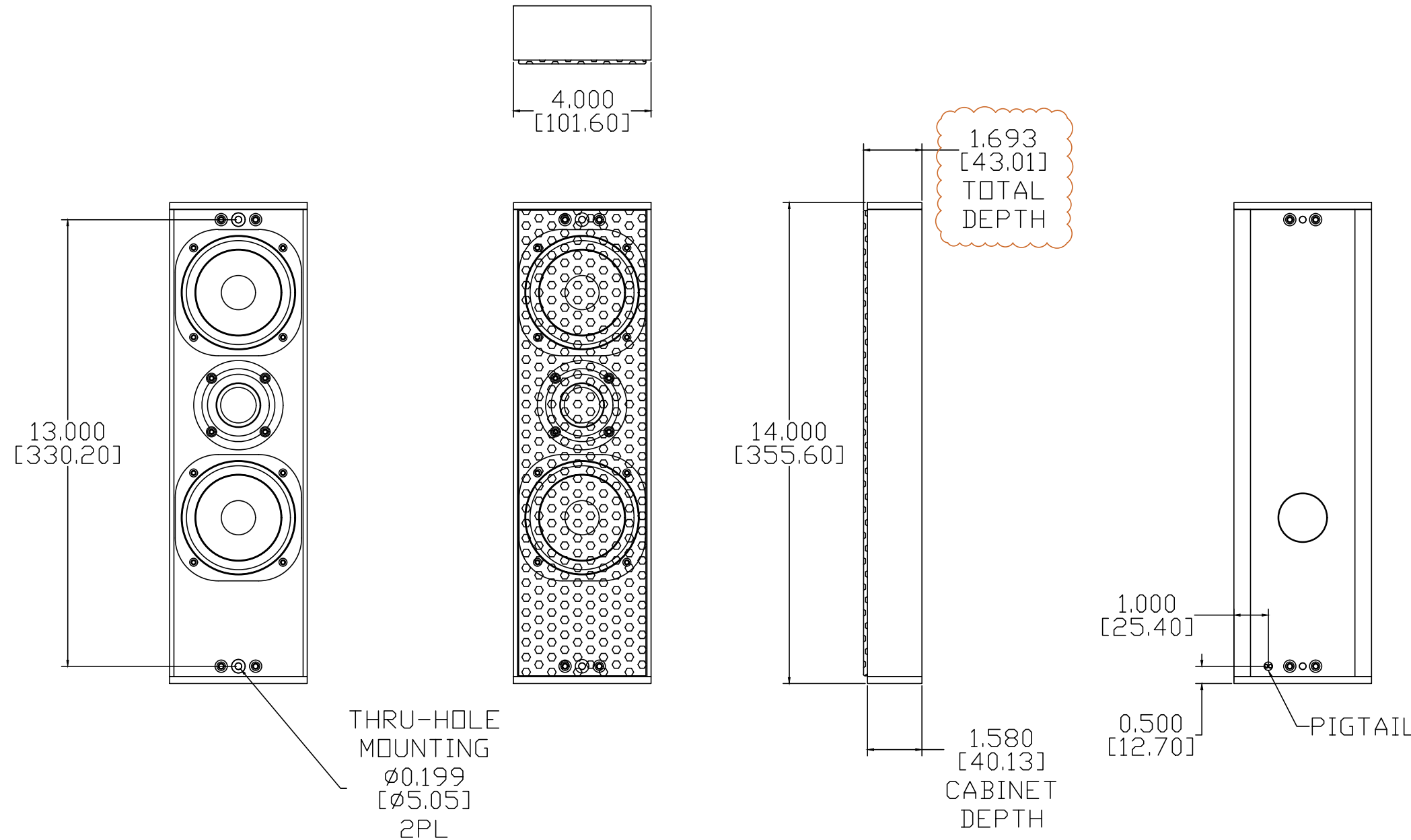

NOTES:

- MATERIAL - USES STANDARD SPL3 EXTRUSION UNLESS OTHERWISE SPECIFIED
- FINISH - TBD

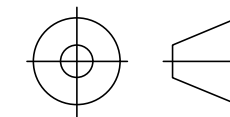

"THIRD ANGLE" PROJECTION

PROPRIETARY INFORMATION
 THE DESIGNS, INFORMATION, AND DATA CONTAINED HEREIN ARE PROPRIETARY AND ARE SUBMITTED IN CONFIDENCE, AND SHALL NOT BE DISCLOSED, USED OR DUPLICATED IN WHOLE OR IN PART, FOR ANY PURPOSES WHATSOEVER, WITHOUT THE PRIOR WRITTEN PERMISSION OF JAMES LOUDSPEAKER LLC, 2185 PARK PL, MINDEN, NV 89423. THIS LEGEND SHALL BE MARKED ON ANY REPRODUCTIONS HEREOF IN WHOLE OR IN PART. RECEIPT OF THIS DOCUMENT SHALL BE DEEMED TO BE AN ACCEPTANCE OF THE CONDITIONS SPECIFIED HEREIN.

JAMES LOUDSPEAKER

OW43

EXTERNAL DIMENSIONS

P/N: -

DWR #: 111012-A00

REVISED BY: B. IJIMA

DRAWN BY: M. GALLES

DATE: 10-12-11

APPROVED:

DRAFTING APPROVED:

SCALE:

TOLERANCES: ANG: $\pm = .5^\circ$ FRACT. $\pm = 1/32$
 DECIMALS: .XX $\pm = .01$.XXX $\pm = .005$

REVISION: F