

REVISIONS				
ECN	REV.	DESCRIPTION	DATE	APPROVED
	A	RELEASE FOR PRODUCTION	10-22-14	
19017	B	DRAWING UPDATED, SWITCHED TO SPL TERMINAL	04-26-19	
19035	C	CROSSOVER, TERMINAL, AND DRIVERS MOVED 70V OPTION ADDED	11-04-19	
21048	D	UPDATE WITH BUTYL TAPE END CAPS	09-14-21	

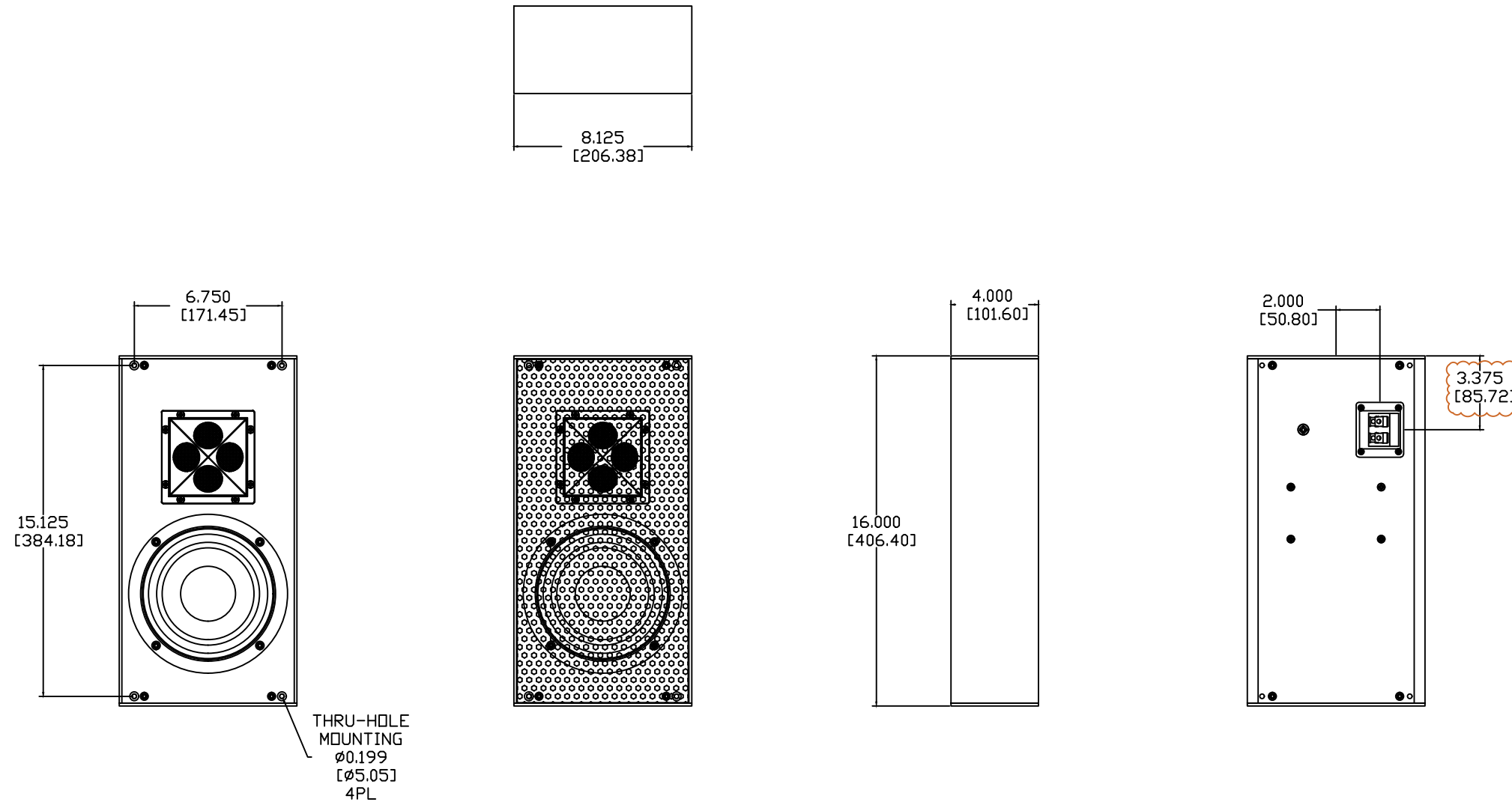

NOTES:

- 1: MATERIAL - SPL6 EXTRUSION  
UNLESS OTHERWISE SPECIFIED
- 2: FINISH - TBD

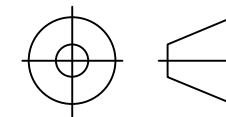

"THIRD ANGLE" PROJECTION

PROPRIETARY INFORMATION  
THE DESIGNS, INFORMATION, AND DATA CONTAINED HEREIN ARE PROPRIETARY AND ARE SUBMITTED IN CONFIDENCE, AND SHALL NOT BE DISCLOSED, USED OR DUPLICATED IN WHOLE OR IN PART, FOR ANY PURPOSES WHATSOEVER, WITHOUT THE PRIOR WRITTEN PERMISSION OF JAMES LOUDSPEAKER LLC, 2185 PARK PL, MINDEN, NV 89423. THIS LEGEND SHALL BE MARKED ON ANY REPRODUCTIONS HEREOF IN WHOLE OR IN PART. RECEIPT OF THIS DOCUMENT SHALL BE DEEMED TO BE AN ACCEPTANCE OF THE CONDITIONS SPECIFIED HEREIN.

JAMES LOUDSPEAKER

OW62Q

EXTERNAL DIMENSIONS

P/N: -

DWR #: 141025-Z00

REVISED BY: B. IJIMA

DRAWN BY: K. EBELING

DATE: 10-25-14

APPROVED:

DRAFTING APPROVED:

SCALE:

TOLERANCES: ANG: ± = .5° FRACT. ± = 1/32  
DECIMALS: .XX ± = .01 .XXX ± = .005

REVISION: D