

## Speaker Installation: For InWall & InCeiling speakers with Frameless grilles.

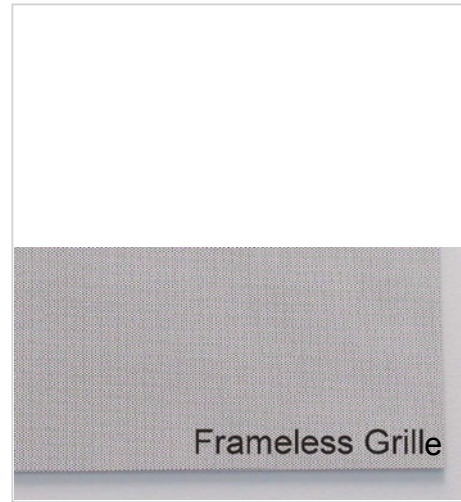

## InWall & InCeiling Speaker - Installation Instructions



Frameless Grille

### Triad InWall/InCeiling Grille

Frameless Grilles are virtually the same size as Wide Frames. Magnetic tape gives them much greater contact area than small magnets, so grilles are held more securely.



**A**

Position speaker speaker template on wall or ceiling in desired speaker location. Level or align. Secure with pushpins or tape, Trace template outline. Cut out speaker hole and remove drywall exposing speaker hole.

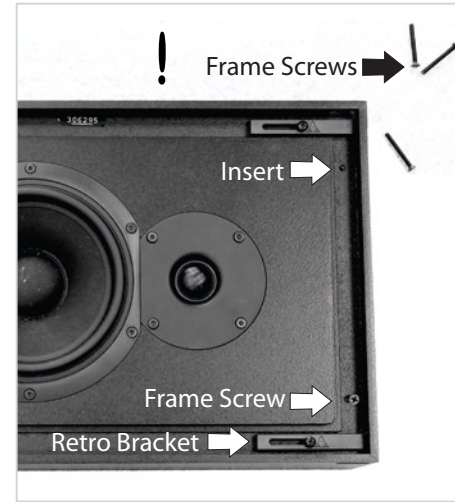

**B**

On speaker face, position the 4 retro brackets horizontally or vertically to extend clear of studs. With brackets retracted, snug screws for InWalls or leave loose for InCeilings. Remove remaining 4 Frame screws so you can install the frame.

! Even if retro brackets or frame are not used, all 8 screws MUST be screwed into front baffle to avoid chuffing noises caused by air forced through open screw inserts.



**C**

With remaining 4 Frame screws 1.5 inch (38mm) x 8-32 \*, screw frame very loosely to speaker front.

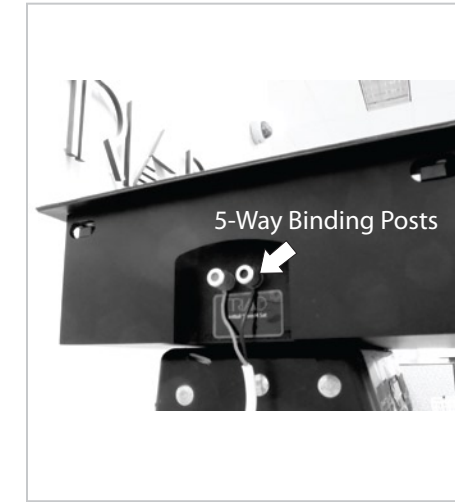

**D**

Connect speaker wires to binding posts, keeping correct phase and polarity with amp (Red+ to Red+ & Black- to Black-). Make sure no loose strands are shorting between binding posts or conductors. Tighten binding posts.



**E**

Insert speaker into hole. Push enclosure back far enough that retrobrackets can clear sheetrock when extended. Use longer screw for thicker walls \*

Loosely attached frame keeps enclosure from falling back into the wall.



**F**

Loosen all 4 retro brackets; extend them fully behind drywall, and tighten. If retro brackets can not clear the back of the drywall, loosen the 4 Frame screws and push the enclosure further back into the wall or ceiling until retro brackets can slide behind drywall. If wall is too thick, use longer Frame screws \*.



**G**

After leveling or aligning speaker, snug the 4 Frame screws to sandwich the drywall \* between grill frame and retro brackets. Do NOT overtighten Frame screws or grille frame can deform and cause buzzing.

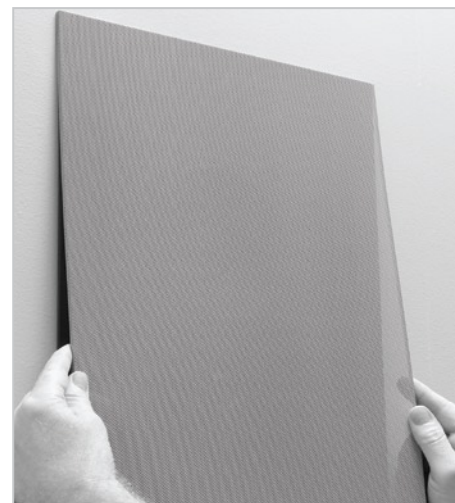

**H**

Attach Frameless grille over its frame.

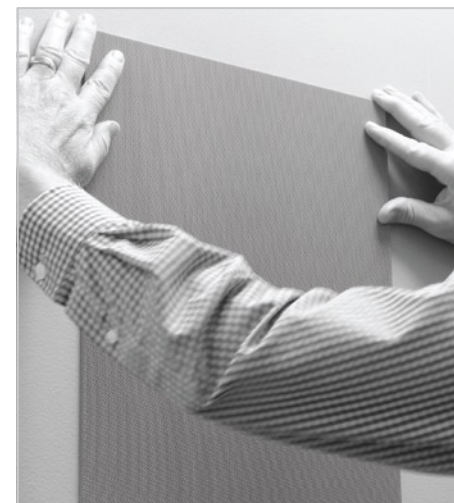

**H**

Seat Frameless grille snugly all around.

\* With standard 1.5 inch (38mm) long 8-32 Frame screws, our speakers fit up to 1.3 inch (33mm) thick wall or ceiling material, enough for 2 layers of 5/8 inch drywall. For thicker walls, replace with longer 8-32 screws. For example, 2 inch (51mm) 8-32 screws fit 1.8" (45.7mm) thick walls & ceilings. Minimum wall thickness is 1/2". Even if retro brackets or frame are not used, ALWAYS leave screws in all front baffle inserts to avoid chuffing noises.